

- FEATURES
1. 1 PIECE ROTATIONALLY MOLDED CONSTRUCTION
 2. TRANSLUCENT COLORS
 3. FDA APPROVED RESIN
 4. UV STABILIZED
 5. CALIBRATED IN GALLONS

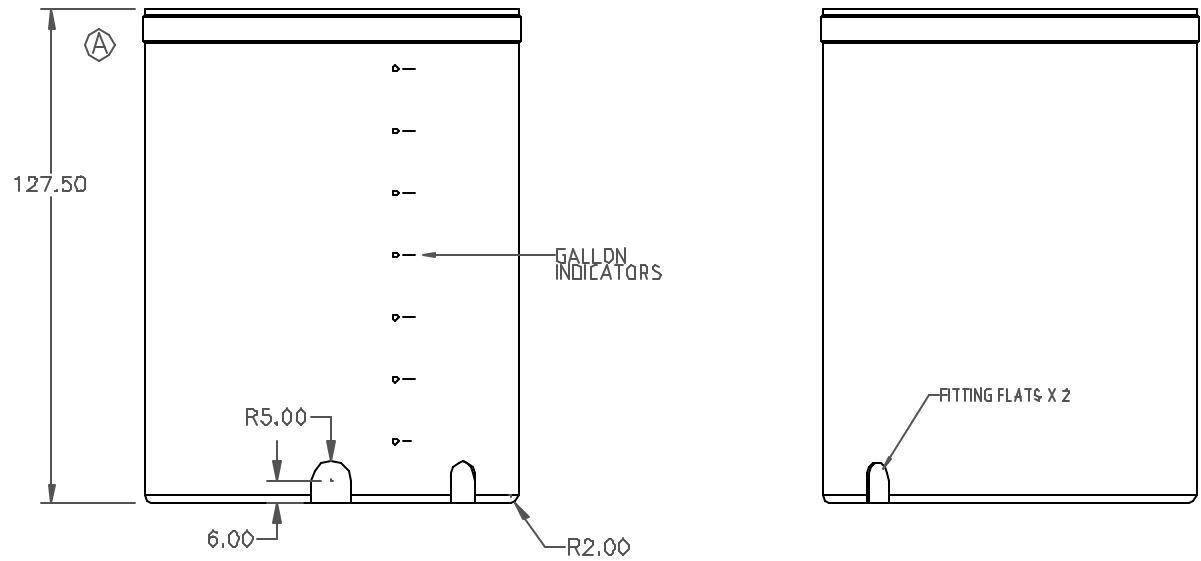
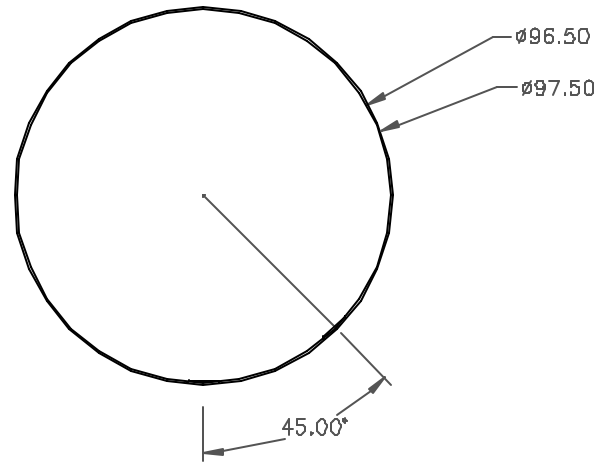

				DRAWN / DATE NVE 6/13/15		MATERIAL	
				APPRD. / DATE DHJ 6/22/15		HDPE OR EQUIVALENT REFERENCE MATERIAL DATA SHEET FOR SPECIFIC PROPERTIES.	
A	CHANGE TOP EDGE CUT	DHJ	2/19/17				
REV	DESCRIPTION	DATE	APPRD				
ALL DIMENSIONS ARE IN DECIMAL INCHES TOLERANCES UNLESS OTHERWISE SPECIFIED $\pm 1\%$ @ 68° F				THIRD ANGLE PROJECTION ANSI 14.5M 		NOTES: 1. .640 WALL THICKNESS AT FLATS 2. WHITE OR COLD R 3. SHOT WEIGHT 625 LBS.	

CSI
 ChemIndustrial Systems, Inc.
 PO Box 500, Cedarburg, WI 53012
 262-375-8570 • (Fax) 262-375-8559 • info@chemindustrial.com

SCALE: N.S. PART NO.: