

KEY	PART NUMBER	DESCRIPTION	QTY.
1	B02500X30000	1/4 X 3 FLAT BAR	336 IN, (4 @ 38', 28', 17.5')
2	P10000	1" SIZE TUBING	145 IN
3	P20000	2" SIZE TUBING	4 @ 54 IN
4	R05000	1/2" MILD STEEL ROD	4 @ 42 IN
5	RAR-12	12" ROLLED ANGLE	1
6	T1000X01090	1" OD ROUND MILD X .109	4 @ 23 IN

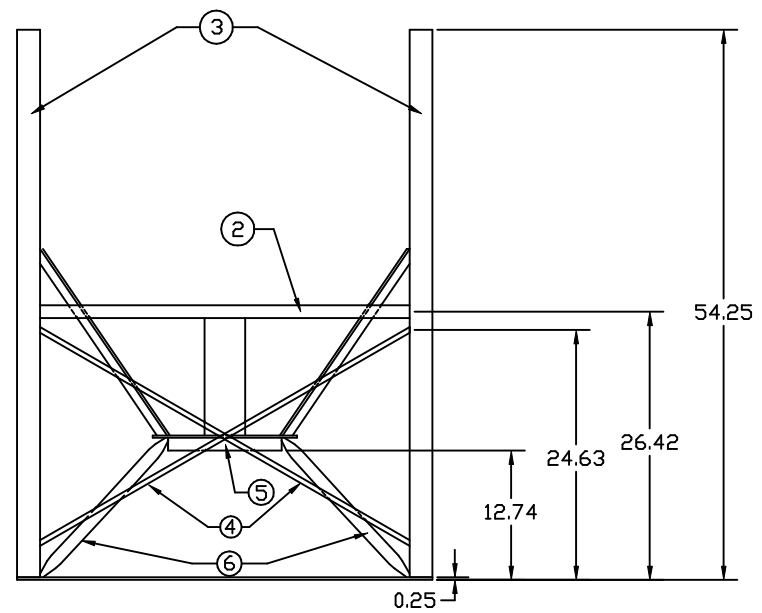
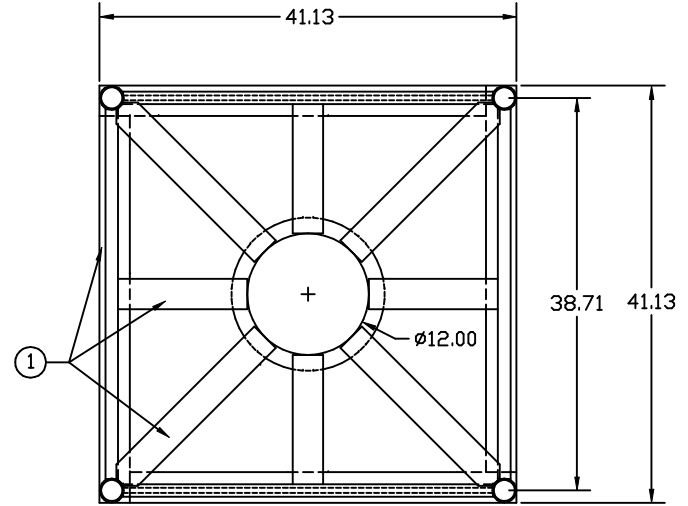

D	ISOLATED STAND, CHANGED PN	5/17/06	NVE
C	CHAGE PART NO. TO CB0345-52	10/5/04	
B	ADD FITTING INFORMATION	10/5/04	
A	FINALIZE PART	9/15/04	
REV	DESCRIPTION	DATE	

DRAWN / DATE	MATERIAL
DHJ / 08/17/04	MILD STEEL
APPRD. / DATE	

CSI
 ChemIndustrial Systems, Inc.
 PO Box 500, Cedarburg, WI 53012
 262-375-8570 • (Fax) 262-375-8559 • info@chemindustrial.com

ALL DIMENSIONS ARE IN DECIMAL INCHES
 TOLERANCES UNLESS OTHERWISE SPECIFIED
 ± 1% @ 68° F

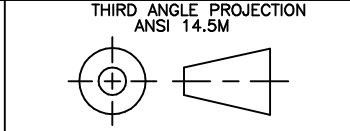

NOTES:
 1. BLACK COLOR -POWDER COATED
 2. WEIGHT 174 LBS.

SCALE N.S.

PART NO.